

74 Series Blocks

- Steel socket connector
- Safety locking head pin
- Built-in handle and hand line hook
- Large widened throat
- Smoothly-contoured conductor guard follows contour of sheave
- Lightweight aluminum alloy sheave
- Shielded ball bearings
- Lubrication fitting

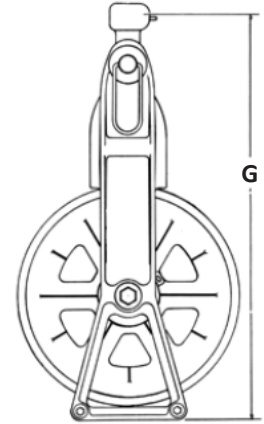
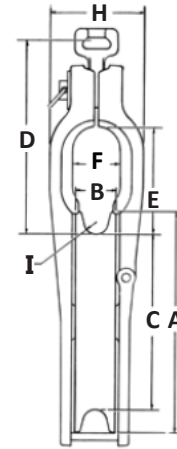
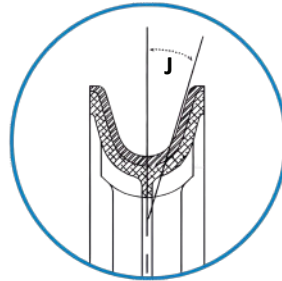

Size (nom.)	Sheave OD (in.)	Rim Width (in.)	Groove Bottom Dia. (in.)		Connection Point to Groove Bottom (in.)		Throat Dimensions (in.)			Height Overall (in.)	Width Overall (in.)	Groove Radius (in.)	Flare Angle (Degrees)	
			Polished Groove	Urethane	Polished Groove	Urethane	Height - Polished Groove	Height - Urethane	Width				Polished Groove	Urethane
	A	B	C		D		E		F	G	H	I	J	
10	10	1 1/4	7 1/16	7 15/16	9 1/2	9 11/32	4 59/64	4 5/64	2 1/8	19 7/16	4 1/4	17/32	13	13
12	12	2	9 5/8	10	9 1/2	9 5/16	5 3/4	4 55/64	2 1/4	20 15/16	4 7/8	19/32	13	13
14	14 19/40	2 1/4	11 76/77	12 1/46	10 3/29	9 33/55	5 1/3	5 7/17	2 3/8	24 1/16	5 3/32	13/20	15	12
16	16 1/2	2 1/4	14	14	10 1/2	10 1/32	5 29/64	5 29/64	2 1/2	26 1/32	5 1/2	23/32	17	15

Size (nom.)	Max. Conductor OD (in.)	Max. Working Load Limit (lb.)	Block Weight (nom.)	Material		Efficiency
				Frame	Sheave	
10	Refer to IEEE Standard 524 (2016)	6,500	11 1/2	A356-T6 aluminum (virgin)		98%
12		6,500	14 1/2			
14		7,500	18			
16		9,000	22			

Additional Fittings



#1 Hook



#8 Clevis



#1 Hook w/ Safety Latch



#3030 Y-Clevis



#6 Oval Eye

Accessories

Block Grounds

Provide direct grounding to the conductor or pulling line via an aluminum or steel sheave to maintain voltage drain for safer working conditions. This sheave applies constant contact against the conductor via spring-action from underneath the wire, which prevents the block from 'yawing.' Block grounds are available in **72, 74 and 78 Series transmission blocks.**