

UNIVERSAL STRINGING BLOCK MODEL XS-100-B

FEATURES

- Can be used in suspension utilizing a high strength, hot dipped galvanized socket connector. (ANSI C-29.2-71)
- Used on crossarms from 5 x 6 in. to 9 1/2 x 7 in. positions with Fastrap® or crossarm* bracket.
- 100% positive locking spring loaded head pin assembly has large hook for hot stick operation.
- Light but extremely rugged.
- Sheave and crossarm* bracket base are heat treated permanent mold castings.
- Low friction sealed ball bearings are lubricated for life of block under normal conditions.
- Four material options available for sheave / groove linings: polished-groove aluminum, urethane on aluminum, ductile iron, and nylon.
- Ductile iron is optimal for unusually rugged applications due to it's resistance to abrasion.

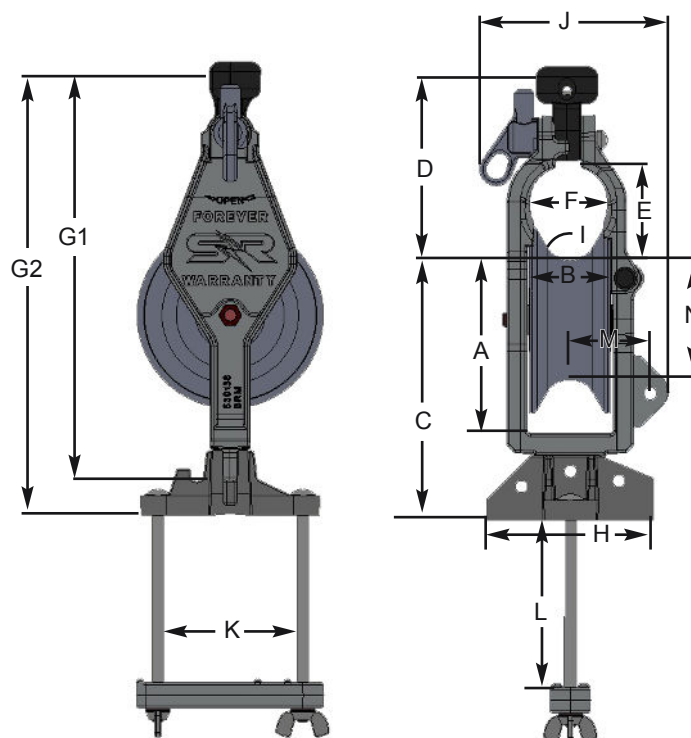

*Crossarm bracket sold separately

COMPLETE DIMENSIONS

SIZE	OUTSIDE SHEAVE DIA. IN.	RIM WIDTH IN.	HEIGHT ABOVE CROSS-ARM IN.	POINT OF CONNECTION TO BOTTOM OF CONDUCTOR IN.	THROAT		OVERALL LENGTH IN.		WIDTH OF CROSSARM BRACKET IN.
					HEIGHT IN.	WIDTH IN.			
	A	B	C	D	E	F	G1	G2	H
7	7	3	9 3/4	6 2/3	3 5/8	3 1/16	14 11/16	15 9/16	6 1/4

RADIUS IN.	WIDTH AT WIDEST POINT IN.	MAXIMUM CROSSARM SIZE IN.		SHEAVE TO MOUNTING HOLE IN.	BOTTOM OF GROOVE DIAMETER
I	J	K	L	M	N
1	7	5	6	3	4.5

SIZE, IN.	MAXIMUM O.D. OF CONDUCTOR, IN.	MAXIMUM WORKING LOAD LIMIT, LB.	BLOCK WEIGHT, LB.	BLOCK WITHOUT BRACKET, LB.
7	1 3/4	2,500	12 1/2	9 1/4



#1 Hook



#1 Hook with Safety Latch



#6 Oval Eye



#8 Clevis



#3030 Y-Clevis

ADDITIONAL MODELS

MODEL XS-200

- XS-200 contains 2 identical sheaves.
- For uplift conditions and can be used either in suspension or on a crossarm.
- Side gate positively locks with spring plunger.
- Available shackle for hold down rope (order separately).
- Maximum working load is 2,500 lb., weight 16 ¼ lb.
- Available in polished groove, nylon or urethane.



XS-200

ACCESSORIES:

ADJUSTABLE INSULATOR ADAPTER

- 2 models available; AIA-CF & AIA-J.
- Used for reconductoring on vertical tie-top post insulators.
- AIA-CF adjusts to fit most insulators with neck dia. for 2-1/8 in. through 3-1/2 in.
- AIA-J adjusts to fit most insulators with neck dia. for 3-1/4 in. through 4-7/8 in.
- Fits all Sherman + Reilly XS-100-B stringing blocks.



AIA-CF

HORIZONTAL LINE POST ADAPTER

- Model: LPA-17-A.
- Used with horizontal line posts.
- Fits in the insulator cap and is held securely in place with the bolt, which is provided for securing the conductor clamp.
- This enables accurate sagging and minimizes handling and lifting of conductor during clipping-in operation.
- Permits placing block at 30 degrees for negotiating angles.



LPA-17-A

GROUNDING STUD

- Provides location to ground block.

Grounding Stud



1210 ADAPTER

- For hanging aerial cable blocks directly to messenger for mid-span support. Will fit any Sherman + Reilly stringing blocks equipped with socket connector.
- Accommodates up to 5/8 in. wire.

1210 Adapter





SHERMAN+REILLY®

UNIVERSAL STRINGING BLOCK

UNIVERSAL STRINGING BLOCK

MODEL XL-100

FEATURES

- Can be used in suspension utilizing a high strength, hot dipped galvanized socket connector. (ANSI C-29.2-71)
- 100% positive locking spring loaded head pin assembly has large hook for hot stick operation.
- Extremely rugged.
- Low friction sealed ball bearings are lubricated for life of block under normal conditions.
- Forever Warranty.®



XL-100 block shown with optional ground

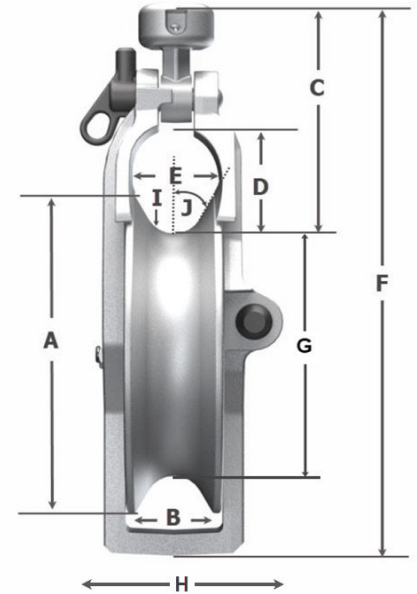

COMPLETE DIMENSIONS

SIZE	OUTSIDE SHEAVE DIA. IN.	RIM WIDTH IN.	INSIDE TOP OF SOCKET TO BOTTOM OF GROOVE	THROAT		OVERALL LENGTH IN.	BOTTOM OF GROOVE SHEAVE DIA. IN.	WIDTH AT WIDEST POINT IN.	GROOVE RADIUS IN.	FLARE ANGLE DEGREES
				HEIGHT IN.	WIDTH IN.					
	A	B	C	D	E	F	G	H	I	J
11.75	11.75	3.375	8.025	3.875	3.1875	20.08	9.0	7.263	1.063	30

SIZE, IN.	MAXIMUM WORKING LOAD LIMIT, LB.	BLOCK WEIGHT, LB.
11.75	5000	17.5

ACCESSORIES
XS-100 FASTRAP®
FEATURES

- Requires less than half the time to mount/dismount compared to ordinary brackets.
- Compatible with nearly all distribution-type stringing blocks.
- One model fits all cross-arm sizes.
- No tools needed to mount or dismount.
- Strong holding force, without damage, regardless of materials.

COMPLETE DIMENSIONS

XS-100 FASTRAP	
Pulling Load, rated	2,500 lb., vertical; 1,500 lb., horizontal
Compatible Cross-Arm Size, max.	4 in. x 10 in.
Compatible Cross-Arm Size, min.	3 1/2 in. x 4 1/2 in.
Operating Mechanism	Encircling strap with manual tightening using a fine-tooth ratcheted lever; released by quick-release lever
Base	Aluminum, with slip-resistant coating
Strap	30 in. length, Polyester, woven, with UV inhibitors & wear indicators
Strap-Assembly Breaking Strength, min.	9,000 lb.
Ratchet Material	Steel, with corrosion-resistant coating
Weight, nom.	6 1/2 lb.
Dimensions, stored, nom.	12 in. x 7 1/4 in. x 6 in.

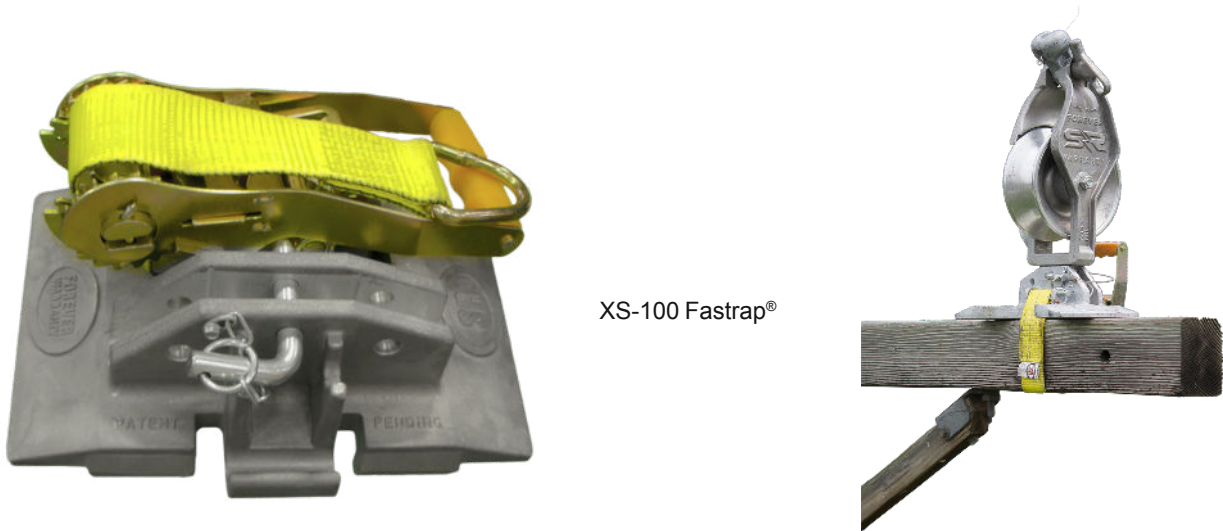

*Specifications are subject to change