



SHERMAN+REILLY®

# UNIVERSAL STRINGING BLOCK

## UNIVERSAL STRINGING BLOCK

### MODEL XL-100

#### FEATURES

- Can be used in suspension utilizing a high strength, hot dipped galvanized socket connector. (ANSI C-29.2-71)
- 100% positive locking spring loaded head pin assembly has large hook for hot stick operation.
- Extremely rugged.
- Low friction sealed ball bearings are lubricated for life of block under normal conditions.
- Forever Warranty.®



XL-100 block shown with optional ground

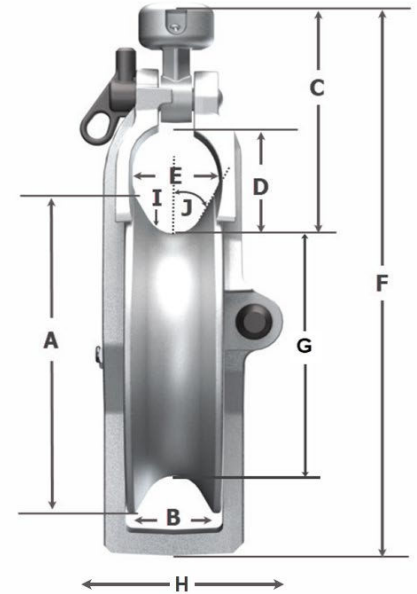

## COMPLETE DIMENSIONS

SIZE	OUTSIDE SHEAVE DIA. IN.	RIM WIDTH IN.	INSIDE TOP OF SOCKET TO BOTTOM OF GROOVE	THROAT		OVERALL LENGTH IN.	BOTTOM OF GROOVE SHEAVE DIA. IN.	WIDTH AT WIDEST POINT IN.	GROOVE RADIUS IN.	FLARE ANGLE DEGREES
				HEIGHT IN.	WIDTH IN.					
	<b>A</b>	<b>B</b>	<b>C</b>	<b>D</b>	<b>E</b>	<b>F</b>	<b>G</b>	<b>H</b>	<b>I</b>	<b>J</b>
11.75	11.75	3.375	8.025	3.875	3.1875	20.08	9.0	7.263	1.063	30

SIZE, IN.	MAXIMUM WORKING LOAD LIMIT, LB.	BLOCK WEIGHT, LB.
<b>11.75</b>	<b>5000</b>	<b>17.5</b>